

GWDW-LED

Construction:

- Injection Molded of Durable Non-Corrosive UV Resistant Resins

Light Source:

- LED
- Dimming to 10% **Included**

Notes:

- Downlight Only
- Center lockup – hardware included
- UL and CUL listed **WET** location
- LED Components
 - Replaceable Module
 - CRI > 80
 - Universal 120/277 volt standard
 - 5-Year Warranty on LED Components

Type:	
Job Name:	

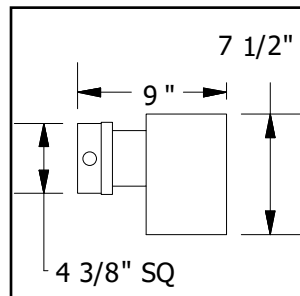
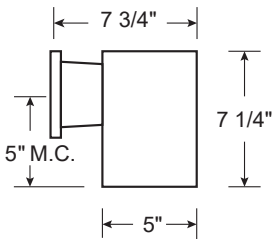

-38 J-Box Option



ORDERING INFORMATION

Example: GWDW-7-LED-U-10ACw-4-B99

GWDW

Size	LED					Kelvin	Cage	Finish	Diffuser	Options
		Watts	Source Lumens	Dimming	Energy Star					
7-LED	F10	10	863	TRIAC/ELV	YES	2 3000K 4 4000K		B99 Black W99 White		DIMLD Line Voltage /TRIAC/ELV/120v See Resource Page
						Optional 3 3500K				90CRI Consult factory 38 Surface mounted Jbox with knockouts



28435 Industry Drive., Valencia, California 91355
 West Coast Sales: 800-325-4448 /661-257-0286 • fax 800-323-2346 /661-257-0201
 East Coast Sales: 866-350-0991 • fax 866-490-5754
 www.lightwayind.com • sales@lightwayind.com

