

# BRLW-LED

## Construction:

- Steel housing and chassis
- Diffuser is .060" thick white textured polycarbonate
- Optional alabaster lenses are .080" thick acrylic

## Light Source:

- LED
- Dimming to 10% **Included**

## Notes:

- Center lockup – hardware included
- Custom cage styles available
- Open top and bottom allows for up/down light
- ADA compliant
- Optional battery backup
- UL and CUL listed **DAMP** location
- LED Components
  - Replaceable Module
  - CRI > 80
  - Universal 120/277 volt standard
  - 5-Year Warranty on LED Components

Type:	
Job Name:	

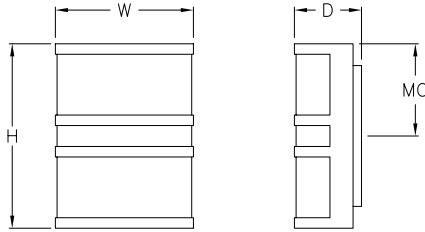

### BRLW-11

Height - 11"  
Width - 7 1/4"  
Depth - 4"



## ORDERING INFORMATION

Example: **BRLW-11-LED-F1H-4-B1-WTP**

### BRLW

Size	LED					Kelvin	Cage	Finish	Diffuser	Options	
		Watts	Source Lumens	Dimming	Energy Star	2 3000K 4 4000K					
11-LED	F1H	9	1400	0-10v	YES	Optional 3 3500K		B1 Satin Black Z1 Satin Bronze Z3 Text Bronze W1 Yolk W2 Gloss White W3 Text White B2 Text Black T4 Shimmer Gray M13 Anod Silver T6 Pewter W13 Pearl Beige	WTP White Textured Polycarbonate	DIM LED dimming driver (0 - 10v) DIMLD Line Voltage /TRIAC/ELV/120v See Resource Page	
	F1O	10	863	TRIAC/ELV	YES				Optional Lens Material (see Price List)	ES Energy Star listed components	
	F1P	15	1361	TRIAC/ELV	YES				AHA Amber Honey Alabaster	T24 Title 24/JA8 Compliant (F10 & F1P configuration only)	
	O2A	12	1600	0-10v	NO				BAA Beige Alabaster	90CRI Consult Factory	
	F1J	20	2820	0-10v	YES				OAA Opal Alabaster	OCCHFB Concealed Occupancy Sensor (O2A Configuration Only) See Sensor Resource Sheet	
							Optional (See Price List)			Battery Backup Options (Available with 0-10v only)	
										BB10 10 Watts (1170lm) for 90-Minutes	



28435 Industry Drive., Valencia, California 91355  
800-325-4448 /661-257-0286  
www.lightwayind.com • sales@lightwayind.com

