

1. ATTACH THE J-BOX MOUNTING BRACKET TO THE J-BOX USING THE PROVIDED (2) #8-32 SCREWS.
2. BEFORE THREADING THE TUBES TO THE COUPLINGS ATTACHED TO THE CHASSIS OF THE FIXTURE, ALIGN AND INSERT THE ROUND CANOPY. NOTE: THE CANOPY WILL BE SECURED AT A LATER TIME.
3. THREAD THE TUBES TO THE COUPLINGS.
4. ALIGN AND INSERT THE TUBE ADAPTER BRACKET ON TOP OF THE TUBE RINGS. NOTE: EACH TUBE SHIPS WITH ONE RING ALREADY THREADED ONTO IT.
5. INSERT THE  $\frac{1}{4}$ " IPS LOCK WASHER AROUND THE THREAD OF EACH OF THE (4) TUBES.
6. THREAD AND TIGHTEN THE  $\frac{1}{4}$ " IPS NUTS TO THE (4) TUBES.
7. INSERT THE 1" NIPPLE TO THE CENTER HOLE OF THE PLATE. INSERT THE  $\frac{1}{8}$ " IPS LOCK WASHER AND THREAD THE  $\frac{1}{8}$ " IPS HEXAGONAL NUTS SO THAT THE NIPPLE IS FIXED TO THE PLATE. LEAVE APPROXIMATELY  $\frac{1}{4}$ " OF THE NIPPLE THREAD EXPOSED AT THE BOTTOM SO THAT THERE IS ENOUGH THREAD FOR THE SQUARE CANOPY TO BE PLACED AND THE CAP NUT TO BE THREADED TO SECURE IT. REMINDER: THE CANOPY IS SECURED AT A LATER TIME.
8. LIFT UP THE FIXTURE AND TIGHTEN THE (2)  $\frac{1}{4}$ "-20 x  $\frac{3}{4}$ " HEXAGONAL HEAD SCREWS TO THE J-BOX MOUNTING BRACKET WHICH WAS FIXED TO THE J-BOX AS INSTRUCTED IN STEP 1.
9. AT THIS TIME, THE TOP PORTION OF THE FIXTURE IS SECURELY HANGING FROM THE CEILING. NOW, BRING THE ROUND CANOPY UP AND THREAD THE CAP NUT TO THE NIPPLE TO SECURE IT.
10. NOTE: AS SHIPPED, THE RING IS SECURED TO THE CHANNEL SUPPORTS WITH CLEVIS AND COTTER PINS. THE REMOVAL OF THESE PINS IS REQUIRED TO SEPARATE THE RING FROM THE ASSEMBLY AND INSTALL THE LENS SINCE IT SHIPS SEPARATELY. UNINSTALL ALL THE COTTER AND CLEVIS PINS TO REMOVE THE RING. INSTALL THE LENS INSIDE THE RING. LIFT UP THE RING AND LENS ASSEMBLY AND SECURE THEM BY INSTALLING THE COTTER AND CLEVIS PINS.

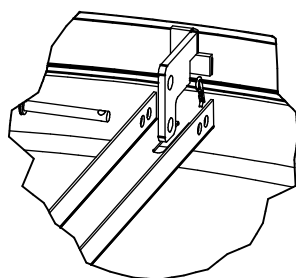

DETAIL A

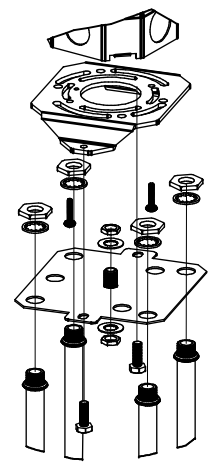

DETAIL B

1. **WARNING** - Turn off the power. Before starting the installation, locate the circuit breaker in the electrical circuit panel and switch the circuit off. *Turning off the light is not sufficient to prevent electrical shock.*
2. **Remove the old fixture.** If you are replacing an existing fixture, remove all components of the old fixture (cover, mounting plate, etc...), remove the old wire connectors, and expose the supply wiring from the electrical box.
3. **Connect the wires.** Use a wire stripper to remove the protective coating of the wires. Connect the grounding wire (green or bare copper wire) from the electrical box to the green wire of the fixture. Connect the white wire from the electrical box to the white wire of the fixture. Connect the black wire from the electrical box to the black wire(s) of the fixture.
4. **IMPORTANT.** Use only *UL Listed* connectors and tape to complete the installation. Carefully read and follow any additional installation instructions provided in this sheet.

<b>LIGHTWAY INDUSTRIES</b>		
VALENCIA CA 91355		
<b>INSTALLATION INSTRUCTIONS</b>		BY RL
DESCRIPTION INSTL-INST-MONH-4S		
DATE 1/23/2015	PART NUMBER 62-175-00	REV 0