

MANW 900 Series

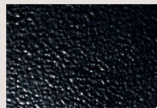

B1 Satin Black



B2 Textured Black



M13 Anodized Silver



T6 Pewter

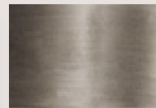

P9 Brushed Nickel

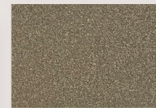

W13 Pearl Beige



W1 Yolk White

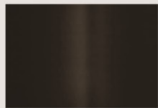

Z1 Satin Bronze



Z3 Textured Bronze



T4 Shimmer Gray



P2 Brushed Aluminum



W3 Textured White

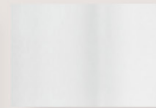

W2 Gloss White



28435 Industry Drive., Valencia, California 91355
West Coast Sales: 800-325-4448 / 661-257-0286 • fax 800-323-2346 / 661-257-0201
East Coast Sales: 866-350-0991 • fax 866-490-5754
www.lightwayind.com • sales@lightwayind.com



Revision: 11/14/2024

MANW-LED-900

Construction:

- Steel housing and chassis
- UV-stabilized, high impact resistant, DR acrylic

Light Source:

- LED
- Dimming to 10% **Included**

Notes:

- Keyhole slots left and right
- Top and bottom white acrylic lens - standard
- Optional photocell (21) increases fixture depth 1 1/2"
- Optional battery backup
- Optional lens cover (NCL) prevents up/down light
- Build America, Buy America Act Compliant
- UL and CUL listed **WET** location
 - Replaceable Module
 - CRI > 90
 - Universal 120/277 volt standard
 - 5-Year Warranty on LED Components

- You may also like the [MERW](#) or [MENW](#) Series

Height - 14" - 16" - 20" - 26" - 38" - 50"

Width - 9"

Depth - 5"

"MC" - 7" - 8" - 10" - 13" - 19" - 25"

- See 600 or 1100 Series for other width options

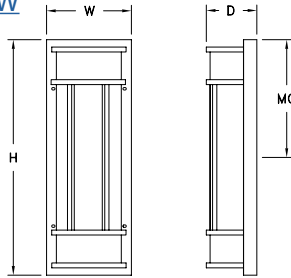

Type:	
Job Name:	

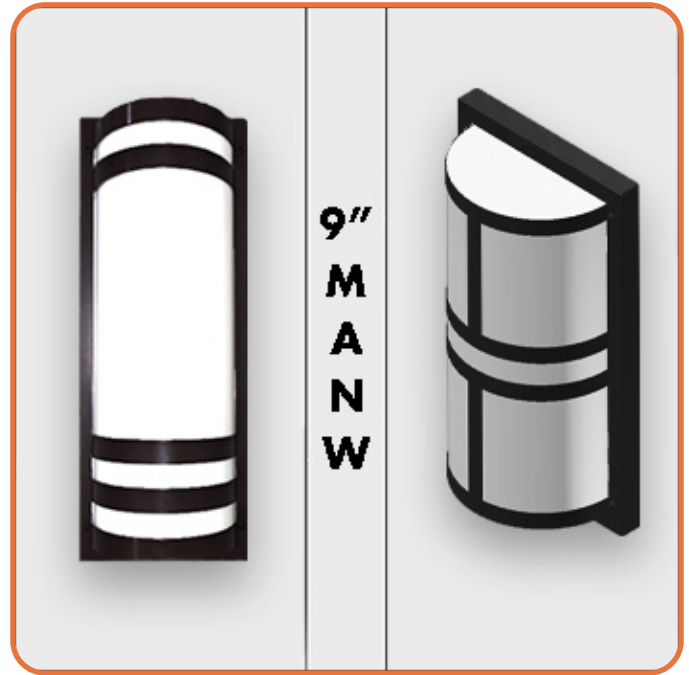

ORDERING INFORMATION

Example: MANW-916-LED-O2C-3-B-Z1-WSA

MANW

Size	LED	Watts	Source Lumens	Dimming	Energy Star	Kelvin	Cage	Finish	Diffuser	Options
914-LED	O1C	9	1210	0-10v	NO	2 3000K 3 3500K 4 4000K	A	B1 Satin Black	WSA White Smooth Acrylic	DIM LED dimming driver (0 - 10v) DIMLD Line Voltage /TRIAC/ELV/120v Consult Factory ES Energy Star listed components 21 Photocell - Specify voltage 01 - 120 volt 02 - 277 volt NCL Lens Cover Top & Bottom 39 J-Box with knockouts on all sides Battery Backup Options (Available with 0-10v only) BB10 10 Watts (1170lm) for 90-Minutes
	F1H	9	1400	0-10v	YES	B	B2 Text Black			
	O2C	18	2420	0-10v	NO	D	Z1 Satin Bronze			
916-LED	O2C	18	2420	0-10v	NO	C	Z3 Text Bronze	Optional (See Price List) M17 Brass Powder P2 Brushed Alum P9 Brushed Nickel		
	O4A	24	3200	0-10v	NO	E	W1 Yolk White			
920-LED	O2C	18	2420	0-10v	NO	F	W2 Gloss White			
	O4A	24	3200	0-10v	NO	X	W3 Text White			
926-LED	O2C	18	2420	0-10v	NO		T4 Shimmer Gray			
	O4C	36	4840	0-10v	NO		M13 Anod Silver			
	F1Y	30	3235	TRIAC/ELV	YES		T6 Pewter			
938-LED	O3C	27	3630	0-10v	NO					
950-LED	O4C29	29	3412	0-10v	NO					
	O8C	72	9680	0-10v	NO					



28435 Industry Drive., Valencia, California 91355
800-325-4448 /661-257-0286 • fax 800-323-2346 /661-257-0201
www.lightwayind.com • sales@lightwayind.com



MANW Series

Cage Styles Options

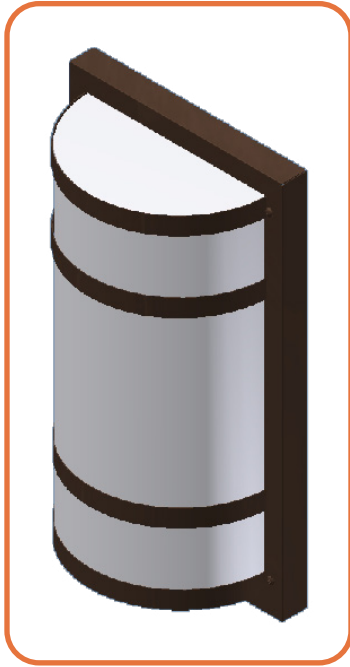

MANW-A

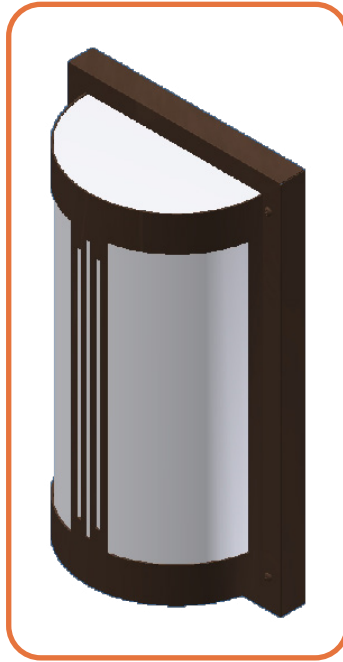

MANW-B

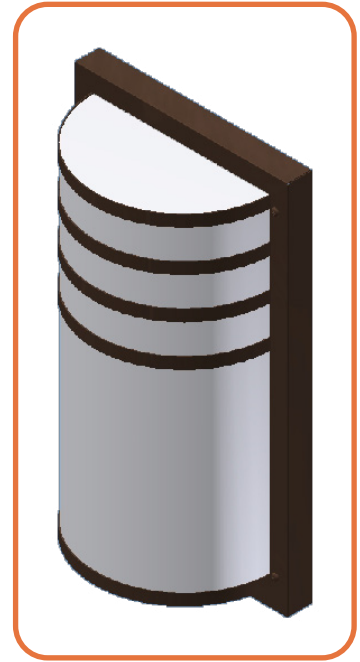

MANW-C

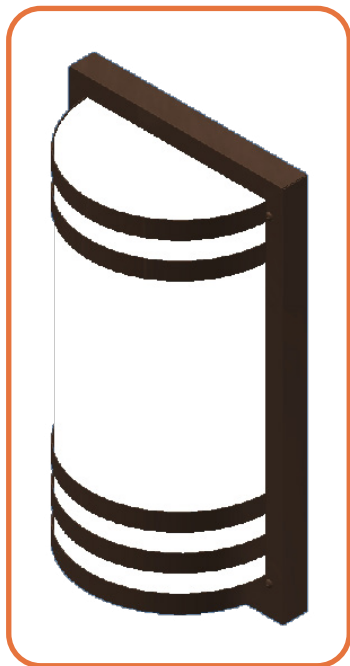

MANW-D

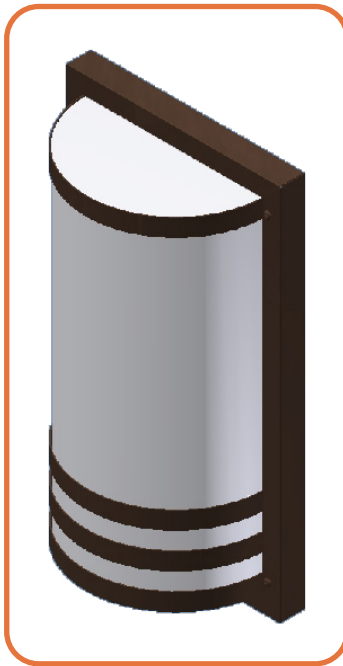

MANW-E

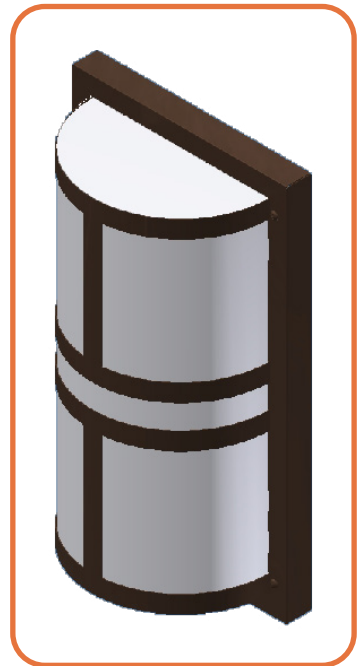

MANW-F



28435 Industry Drive., Valencia, California 91355
800-325-4448 / 661-257-0286 • fax 800-323-2346 / 661-257-0201
www.lightwayind.com • sales@lightwayind.com



Revision: 11/14/2024